

## **300M VGA KVM Extender**

**#VKE3011A10**

VGA KVM Extender VKE3011A10, uses single UTP LAN cable CAT5e/6 to substitute VGA cable to achieve long distance transmission, the transmission distance extend up to 300 meters under 1920\*1200@60Hz. Support EDID pass through, best compliant with different display devices.

### **Application:**

This product can be used on remote DVR for Security System, servers in data centre and monitor room

### **Features**

- Resolution up to 1920\*1200@60Hz over CAT5e/6 UTP/FTP cable up to 300 meters.
- With smart brightness and contrast adjustment algorithm, easy to adjust 0-15 gain levels to match 0-300 meters UTP/FTP cable
- Smart gain control, effective for common mode noise suppression, keep high fidelity picture quality even by 300 meters transmission.
- Easy to control PC remotely with transmitting keyboard and mouse data
- EDID pass through, compatible with most display devices

### **Package Included**

- 1\* VGA KVM Transmitter
- 1\* VGA KVM Receiver
- 2\* DC 5V 1A Power Adapter
- 1\* Quick-Start Guide

## Panel description:

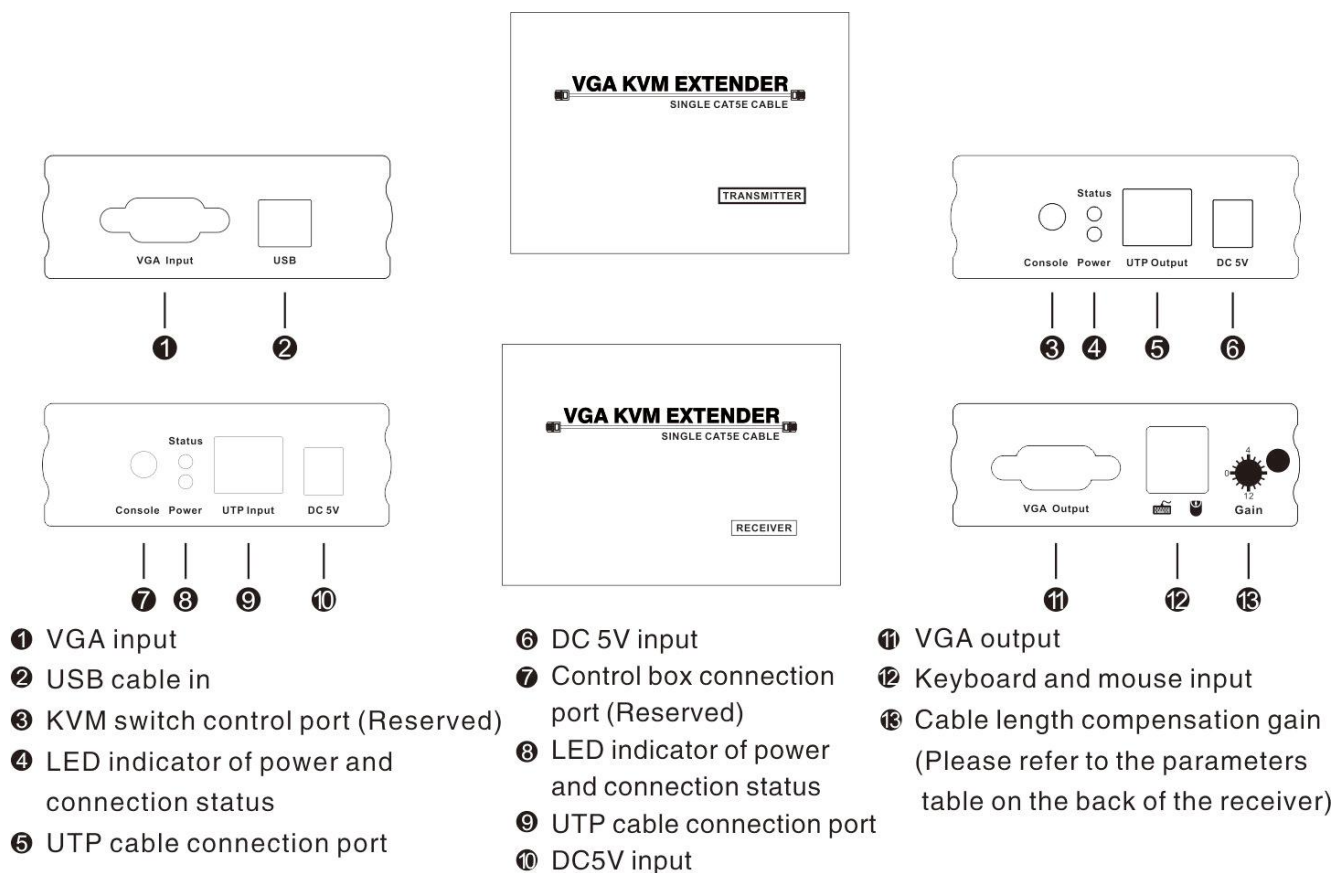

## Connection Diagram:

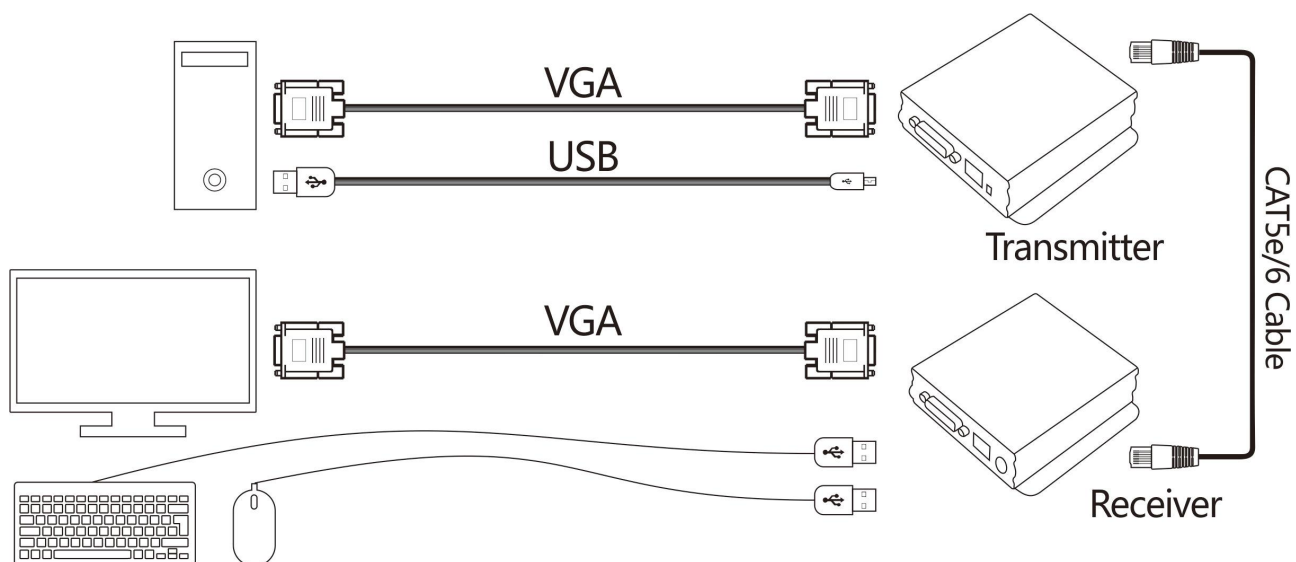

## Specification

VKE3011A10	300M VGA KVM Extender	
Technical		
Max. resolution	1920*1200@60Hz	
EDID pass through	Yes	
Video bandwidth	138 MHz	
ESD protection	Human body model - ±8kV (Air-gap discharge)	
Input	Transmitter: 1* VGA Receiver: 1*RJ45, 2* USB Type A (Keyboard & mouse)	
Output	Transmitter: 1*RJ45, 1* USB Type B Receiver: 1* VGA	
Mechanical		
Chasing material	Aluminum Alloy	
Power supply	DC 5V 1A	
Operating/Storage temperature	0 to 70 degree/-40 to 85 degree	
Operating Humidity	10 to 90% RH	
Product	Dimension	TX:94 (L) x 103 (W) x 30 (H) mm RX:94 (L) x 103 (W) x 30 (H) mm
	Weight	TX:167g RX:170g
Item	Dimension	245 (L) x 135 (W) x 90 (H) mm
	Weight	687g
Carton	Dimension	515 (L) x 285 (W) x 470 (H) mm
	Quantity	20pcs
	Total Weight	14.59kg